

NOTE:

1. CONTRACTOR SHALL BEGIN SITE GRADING AT THE SOUTHEAST CORNER OF THE PROPERTY BY STRIPPING TOPSOIL AND INSTALLING THE WET POND AND INFILTRATION BASIN. EXCAVATED MATERIAL SHALL BE PLACED UPSTREAM OF THE POND AS IT IS BEING COMPLETED. UPON COMPLETION OF THE WET POND, TOPSOIL STRIPPING AND SITE GRADING FOR THE REMAINDER OF THE SITE MAY CONTINUE.
2. UPON COMPLETION OF THE WET POND, THE INFILTRATION BASIN SHALL BE CONSTRUCTED TO WITHIN 1' OF FINISHED GRADE. UPON COMPLETION OF CONSTRUCTION, CONTRACTOR SHALL REMOVE SEDIMENT THAT HAS ACCUMULATED AND BRING INFILTRATION BASIN TO FINISHED GRADE.
3. FINAL GRADES AND RESTORATION OF PARK AREA TO BE COMPLETED UNDER PHASE 2B.

TOP OF BANK ELEV. = 932.0 - A (SURFACE) = 3,150 SF
 UTILIZE SWALE THAT IS TO BE CONSTRUCTED
 AND CLOSE OFF NORTHEAST CORNER TO
 CONTAIN RUNOFF. MIN. DEPTH SHALL BE 3' OVERFLOW
 AT ELEV. 1031.0 ON EAST END OF TRAP.

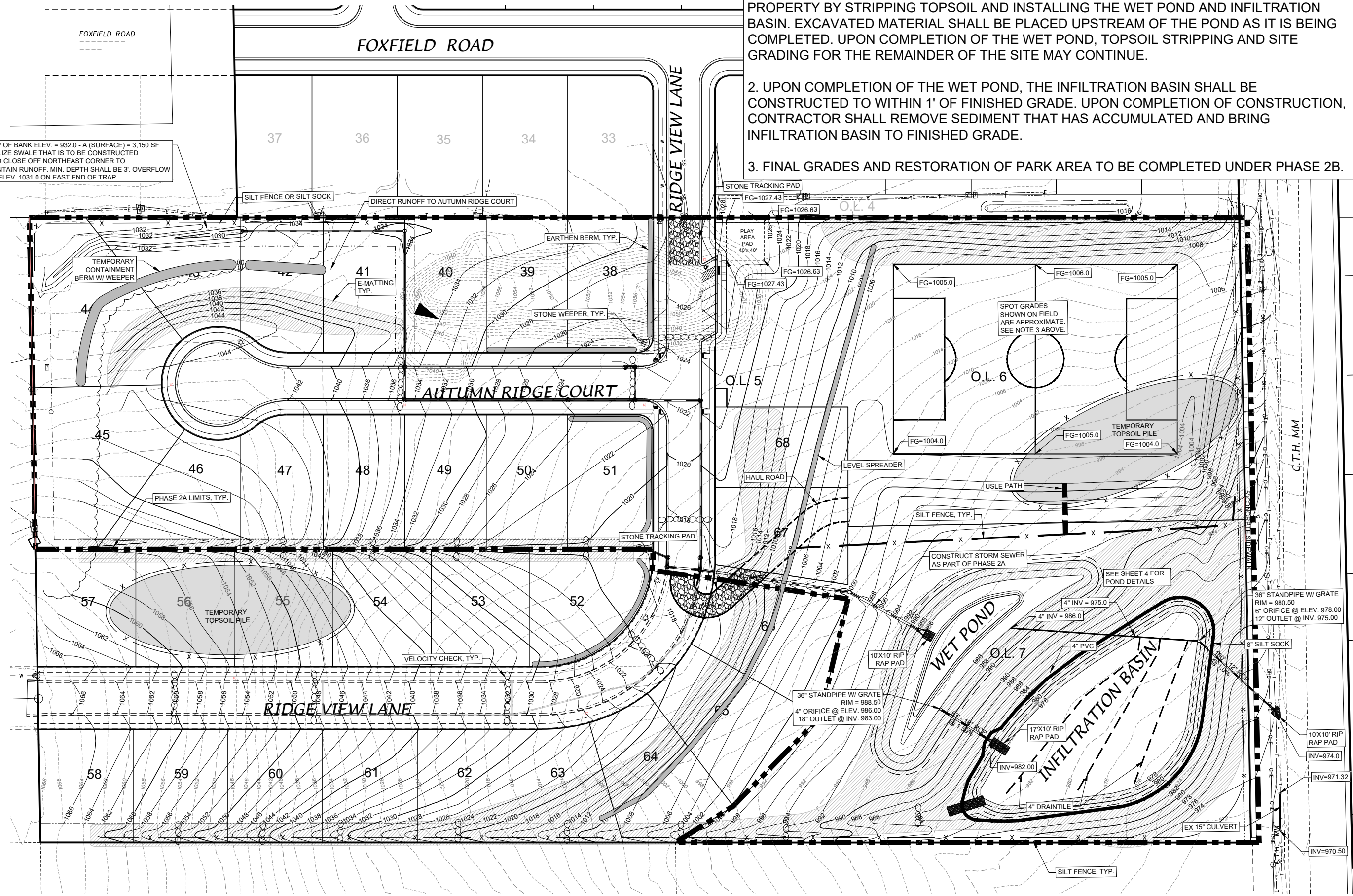

1ST ADDITION TO AUTUMN RIDGE - PHASE 2A

GRADING & EROSION CONTROL

VILLAGE OF OREGON, DANE COUNTY, WISCONSIN



SCALE: 1" = 100'
 (PAGE SIZE: 11x17)
 0 50

DATE: 12/06/2021

DRAWN BY: TCF
 FN: 20-05-162
 Sheet Number:
 2 OF 20